

Tefal[®]

inicio

EN

RC



www.tefal.com

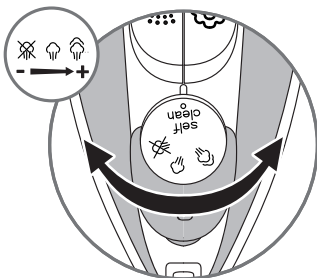
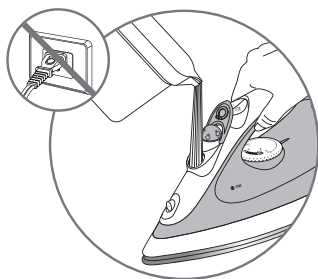



auto-stop

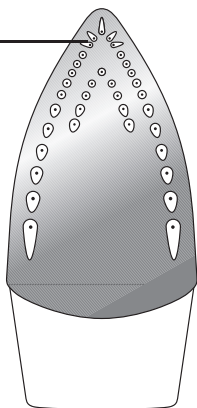
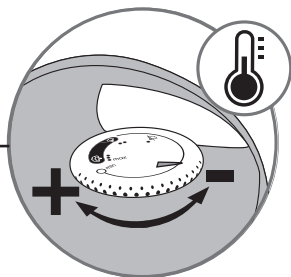
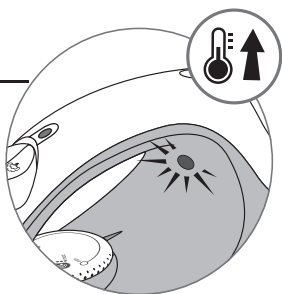
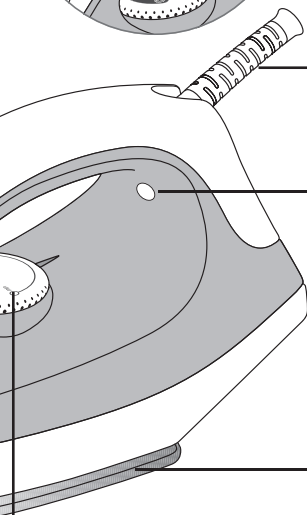
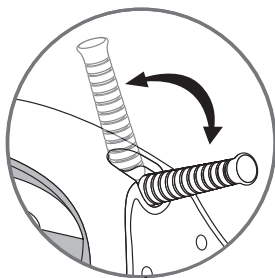

1. EN First use / RC 第一次使用

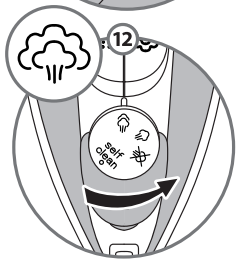
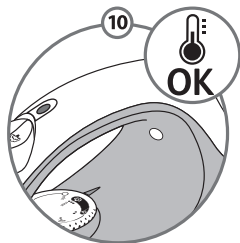
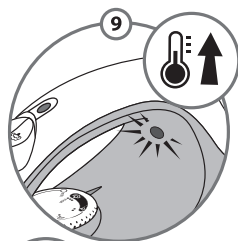
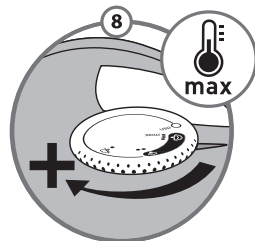
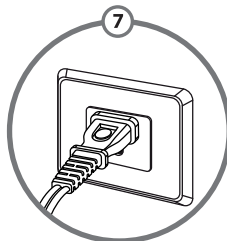
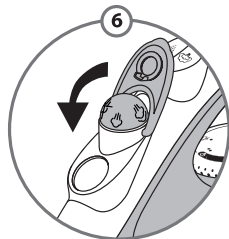
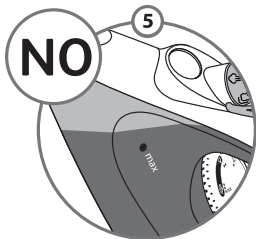
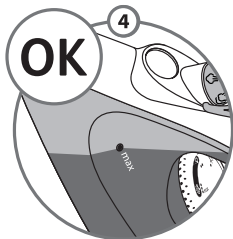
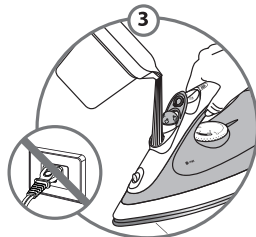
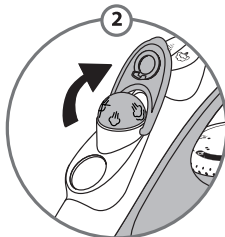
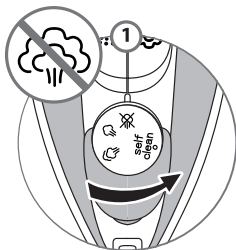
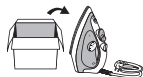

1. EN First use / RC 第一次使用

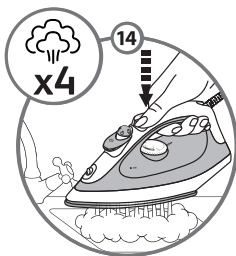
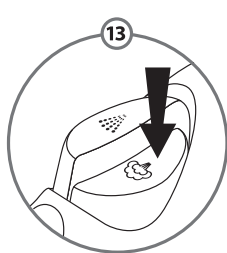
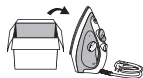

2. EN Water tank filling / RC 水箱注水

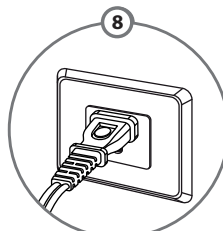
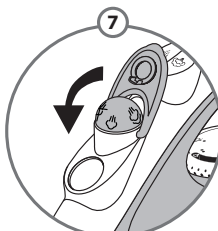
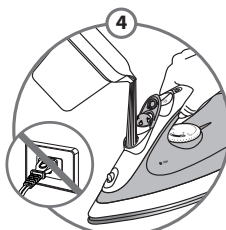
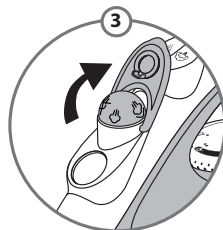
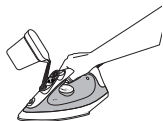
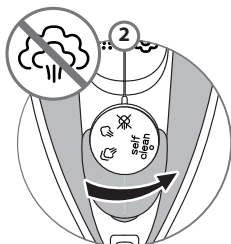
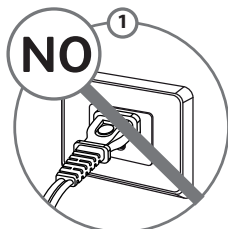

3.1. EN Temperature setting / RC 温度设定

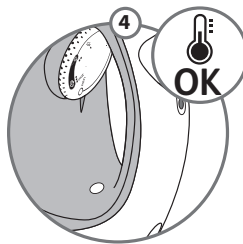
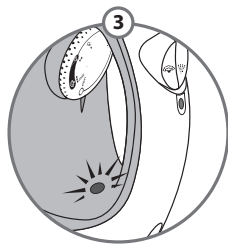
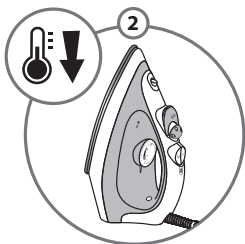
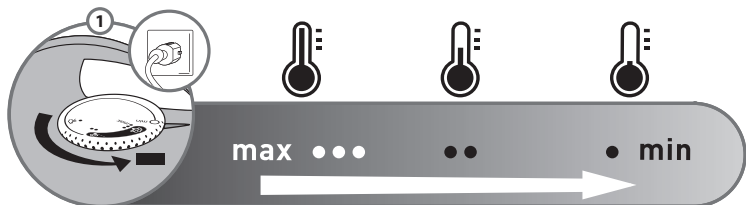
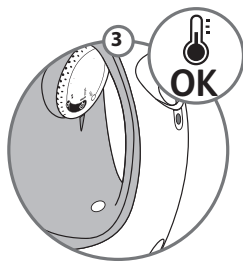
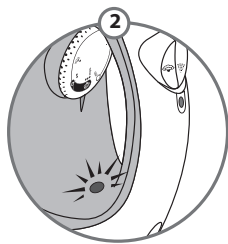
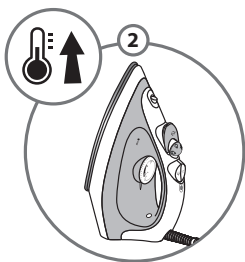
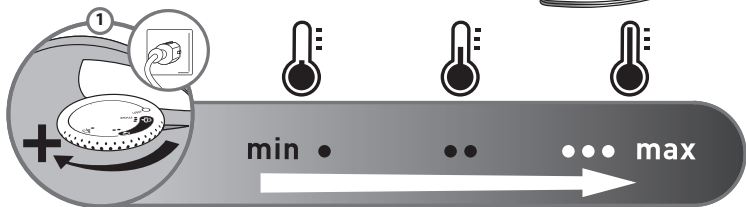
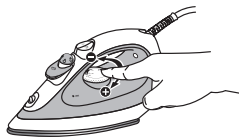

3.2. EN Steam setting / RC 蒸汽设定

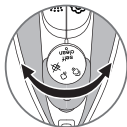

	<p>min • •• max</p>
	<p>•• ••• max</p>
	<p>••• max</p>

4. EN Extra steam / RC 强蒸汽

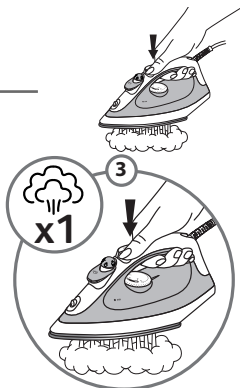
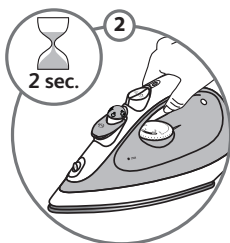
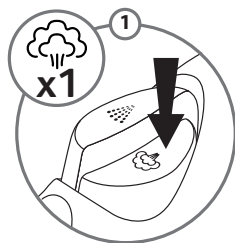

5. EN Spray / RC 喷水

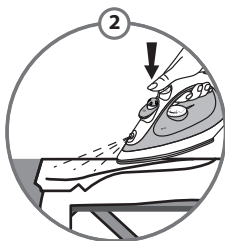
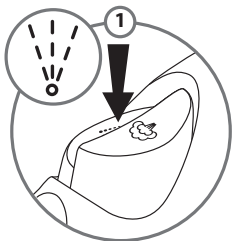

6. EN Vertical steam / RC 立体垂直熨烫

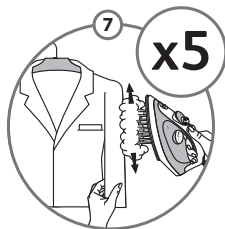
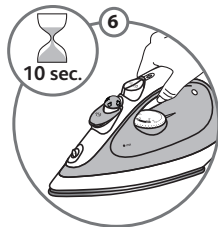
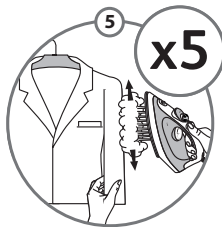
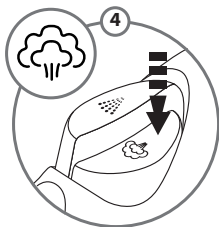
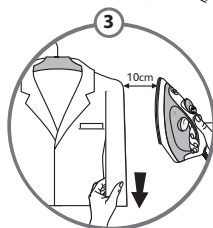
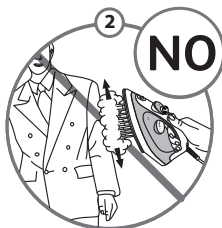
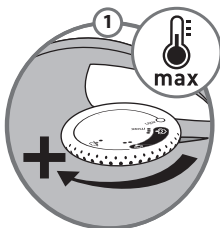

7. EN Iron storing / RC 储藏熨斗

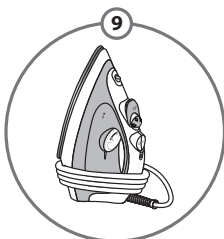
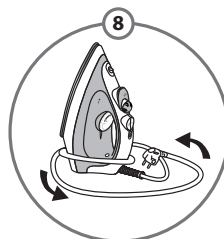
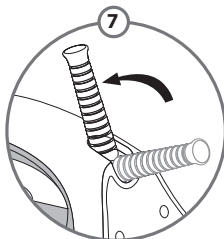
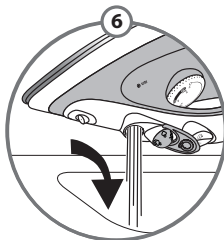
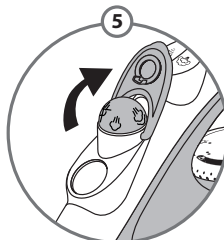
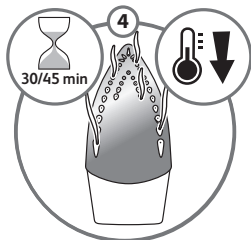
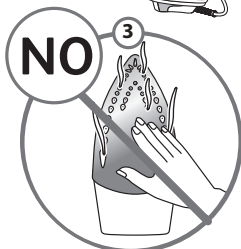
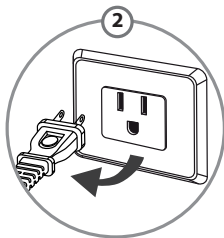
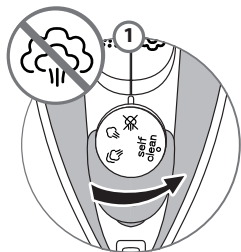

8. EN Anti-calc valve cleaning (once a month) / RC 清洗防钙阀门
(每月一次)

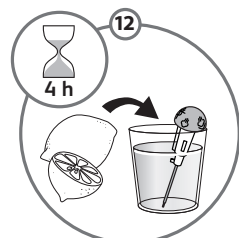
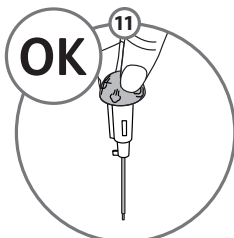
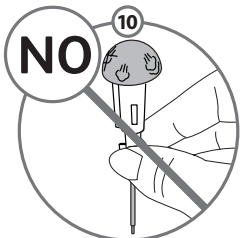
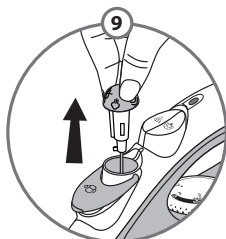
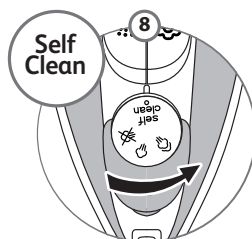
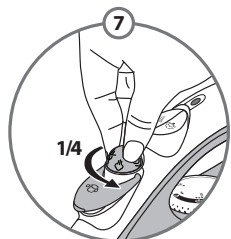
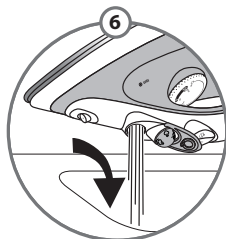
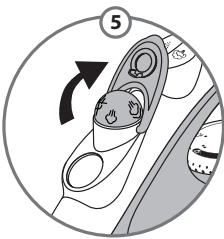
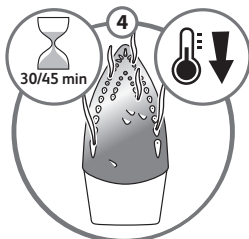
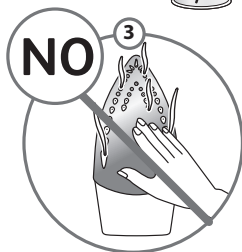
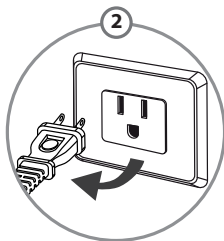
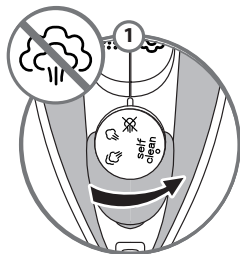

8. EN Anti-calc valve cleaning (once a month) / RC 清洗防钙阀门
(每月一次)

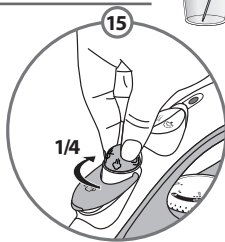
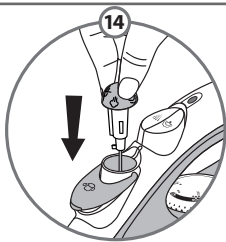
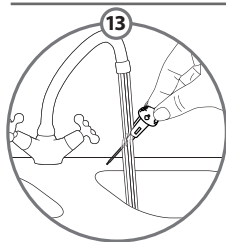

9. EN Self-cleaning (once a month) / RC 自动清洗 (每月一次)

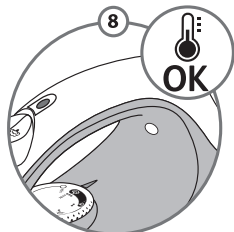
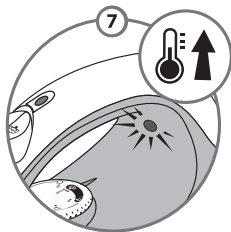
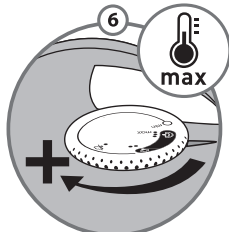
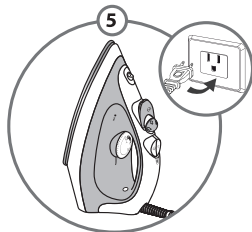
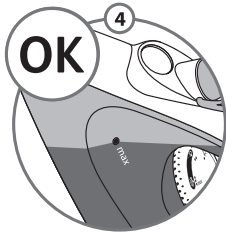
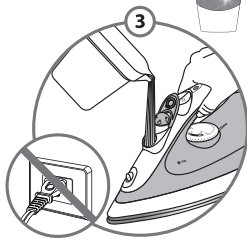
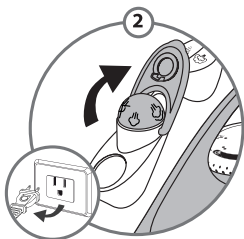
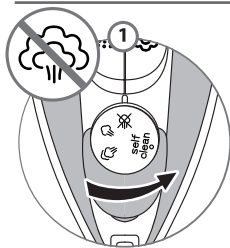

9. EN Self-cleaning (once a month) / RC 自动清洗 (每月一次)

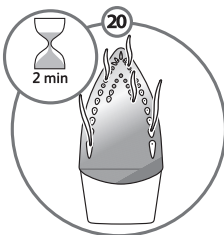
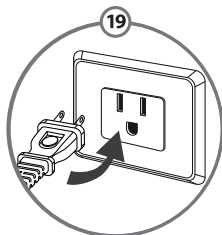
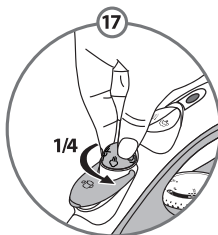
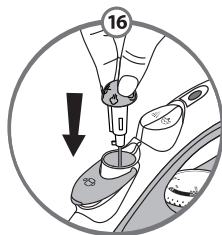
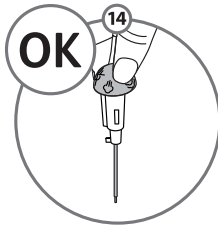
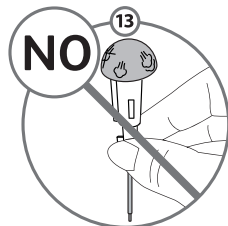
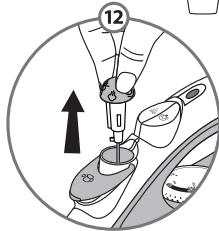
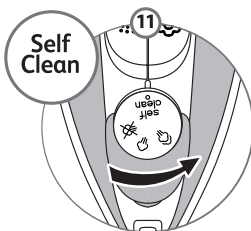
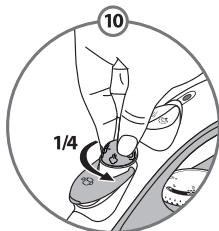

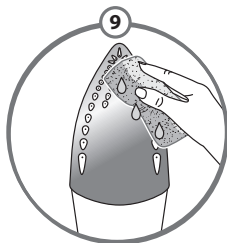
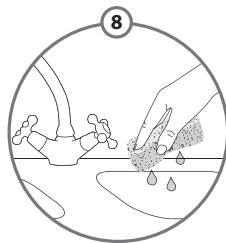
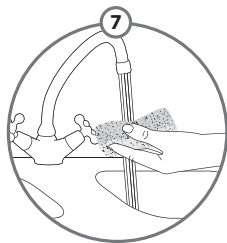
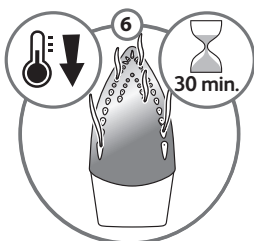
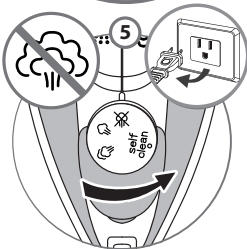
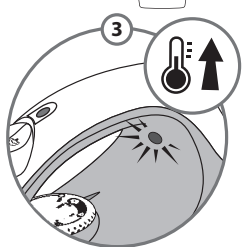
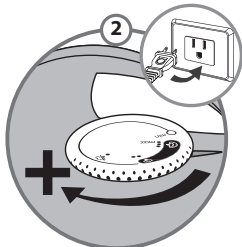
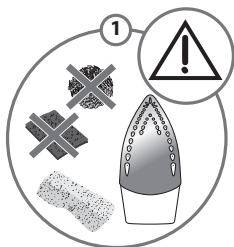
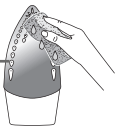

IMPORTANT SAFETY INSTRUCTIONS

Read all instructions before using the iron.

When using your iron, basic safety precautions should always be followed, including the following:

1. Use iron only for its intended use.
2. To protect against a risk of electric shock, do not immerse the iron in water or other liquids.
3. Always turn the iron OFF before plugging or unplugging the iron from the electrical outlet. Never pull on the cord to disconnect the iron from the electrical outlet; instead, grasp the plug and pull on the plug to disconnect the iron.
4. Do not allow cord to touch hot surfaces. Let iron cool completely before putting away. Loop cord loosely around iron when storing.
5. Always disconnect iron from electrical outlet when filling with water or emptying and when not in use.
6. Do not operate iron with a damaged cord or if the iron has been dropped or damaged. To avoid the risk of electric shock, do not disassemble the iron. Contact our Consumer Service Department for examination, repair or adjustment. Incorrect reassembly can cause a risk of electric shock when the iron is used.
7. Close supervision is necessary for any appliance being used by or near children. Do not leave iron unattended while connected or on an ironing board.
8. Burns can occur from touching hot metal parts, hot water or steam. Use caution when you turn a steam iron upside down - there may be hot water in the reservoir.
9. This appliance is only for domestic and personal use.

SPECIAL INSTRUCTIONS

1. To avoid a circuit overload, do not operate another high-wattage appliance on the same circuit.
2. If an extension cord is absolutely necessary, a 15 amp. cord should be used. Cords rated for less amper may overheat. Care should be taken to arrange the cord so that it cannot be pulled or tripped over.

SAVE THESE INSTRUCTIONS FOR YOUR SAFETY

PLEASE READ THESE INSTRUCTIONS CAREFULLY AND KEEP THEM FOR FUTURE REFERENCE.

- Please read these instructions carefully before first use. This product has been designed for domestic and indoor use only. Any commercial use, inappropriate use or failure to comply with the instructions, the manufacturer accepts no responsibility and the guarantee will not apply.
- This appliance complies with the technical rules and standards for safety currently in force (Electromagnetic Compatibility, Low Voltage, Environnement).
- This appliance is not intended for use by persons (including children) with reduced physical, sensory or mental capabilities, or lack of experience and knowledge, unless they have been given supervision or instruction concerning use of the appliance by a person responsible for their safety. Children must be supervised to ensure that they do not play with the appliance.
- **During the first few uses, a harmless odour and a small amount of smoke may be given off. This has no effect on the use of the iron and will disappear quickly.**
- **Warning ! The voltage of your electrical installation must correspond to that of the iron (110V). Connecting to the wrong voltage may cause irreversible damage to the iron and will invalidate the guarantee.**
- If it is absolutely essential to use an extension cable, choose a 15 amp one.
- This iron must always be plugged into an earthed socket.

- If the electrical cord becomes damaged, it must be immediately replaced by an Approved Service Centre to avoid any danger.
- The appliance should not be used if it has fallen, if it has obvious damage, if it leaks or functions incorrectly. Never dismantle your appliance : have it inspected by an Approved Service Centre, so as to avoid any danger.
- Never immerse your iron in water !
- Do not unplug your appliance by pulling on the cord. Always unplug your appliance: before filling or rinsing the water tank, before cleaning it, after each use.
- Never leave the appliance unattended when it is connected to a power source or if it has not cooled down for approximately 1 hour.
- Your appliance gives off steam, which may cause burns. Take extra care especially when you are ironing close to the edge or on a corner of your ironing board. Never direct the steam towards people or animals.

- 
- Your iron should be used and placed on a flat, stable, heat-resistant surface. When you put your iron onto its iron rest, make sure that the surface on which you put it is stable.
 - This product has been designed for domestic and indoor use only. Any commercial use, inappropriate use or failure to comply with the instructions, the manufacturer accepts no responsibility and the guarantee will not apply.
 - This appliance may be used by children aged 8 or over and persons lacking appropriate knowledge or experience or persons with reduced or impaired physical, sensory or mental capacities provided that they have been thoroughly instructed regarding use of the appliance, are supervised, and understand the risks involved. Children shall not play with the appliance. Cleaning and user maintenance shall not be made by children without supervision. Keep the iron and its cord out of reach of children less than 8 years of age when it is energized or cooling down.

What water to use?

Your appliance has been designed to function with untreated tap water. However, it is necessary to operate the Self-Clean function regularly in order to eliminate hard water deposits from the steam chamber.

If your water is very hard (check with your local water authority), it is possible to mix untreated tap water with store-bought distilled or demineralised water in the following proportions : - 50% untreated tap water, - 50% distilled or demineralised water.

Types of water not to use?

Heat concentrates the elements contained in water during evaporation. The types of water listed below contain organic waste or mineral elements that can cause spitting, brown staining, or premature wear of the appliance : water from clothes dryers, scented or softened water, water from refrigerators, batteries or air conditioners, pure distilled or demineralised water or rain water should not be used in your Tefal iron. Also do not use boiled, filtered or bottled water.

Auto-Stop safety feature (depending on model)

- The electronic system cuts off the electric power and the Auto-Stop warning light flashes if the iron is left vertically on its heel for more than 8 minutes, or in a horizontal position for more than 30 seconds.
- To restart the iron, just move it gently until the warning light stops flashing.

The auto-stop light will be lit during normal use!

Environment



Environment protection first !

- ① Your appliance contains valuable materials which can be recovered or recycled.
- ➡ Leave it at a local civic waste collection point.

If there is a problem?

PROBLEM	POSSIBLE CAUSE	SOLUTION
Water drips from the holes in the soleplate.	The chosen temperature is too low and does not allow for the formation of steam.	Position the thermostat in the steam range (from ●● to MAX).
	You are using steam while the iron is not hot enough.	Wait until the thermostat light goes out.
	You are using the Shot of Steam button too often.	Wait a few seconds between each use of the button.
	There is too much steam.	Reduce the steam.
	You have stored the iron horizontally, without emptying it and without setting it to ☹.	See the section "Storing your iron".
The iron drips when you start ironing.	You have removed the anti-scale rod to fill your iron.	Do not extract the anticalc valve when filling the iron.
Brown streaks come through the holes in the soleplate and stain the linen.	You are using chemical descaling agents.	Do not add any descaling agents to the water in the water tank.
	You are not using the right type of water.	Perform a self-cleaning operation and consult the chapter "What water should I use?".
	Fabric fibres have accumulated in the holes of the soleplate and are burning.	Perform the self-cleaning operation and clean the soleplate with a damp sponge. Vacuum the holes of the soleplate from time to time.
	Your linen has not been rinsed sufficiently or you have ironed a new garment before washing it.	Make sure that your laundry is rinsed sufficiently so as to remove any deposits of soap or chemical products on new clothes.
The soleplate is dirty or brown and can stain the linen.	You are ironing with an inappropriate program (temperature too high).	Clean the soleplate as indicated above. Select the appropriate program.
	You are using starch.	Clean the soleplate as indicated above. Always spray starch onto the reverse side of the fabric to be ironed.
There is little or no steam.	The water tank is empty.	Fill it.
	The anti-calc valve is dirty.	Clean the anti-calc valve.
	Your iron has a build-up of scale.	Clean the anti-calc valve and carry out a self-clean.
	Your iron has been used dry for too long.	Carry out a self-clean.
The soleplate is scratched or damaged.	You have placed your iron flat on a metallic rest-plate or ironed over a zip.	Always set your iron on its heel. Do not iron over zips.
Steam or water come from the iron as you finish filling the tank.	The steam control is not set to the ☹ position.	Check that the steam control is set to the ☹ position.
	The water tank is overfilled.	Never exceed the Max level.
The spray does not spray.	The water tank is not filled enough.	Fill up the water tank.

If you have any problem or queries, please contact our Customer Relations team first for expert help and advice.

为了您的安全

- 本产品符合现行安全技术规范和标准（电磁兼容性、低电压、环境）。
- 本产品不适宜儿童使用，亦不适宜其他有生理、智力残疾人士在无人协助或监督的情况下使用。应确保儿童不随意玩耍本产品。
- 警告！接电电压必须与熨斗电压（110V）相符。
连接至错误的电压将造成熨斗损坏，且不在保修范围内。
- 熨斗必须插在已接地的插座上。如使用延长线，必须确保其为正确的安培数（15 A），并已接地。
- 如电源线损坏，必须立即由认可的客户服务中心进行更换，以避免可能造成的危险。
- 如熨斗跌落，明显破损、渗漏或出现功能故障则不可使用。切勿自行拆开机器，应由认可的客户服务中心进行检修，以避免可能造成的危险。
- 切勿将熨斗浸泡在水中！
- 切勿以拉拽电源线的方式切断电源。在每次注水、倒水、清洗水箱前和使用后，请断开电源。
- 当熨斗在接通电源时或尚未冷却完毕的一小时之内，切勿将其置于无人监管状态。
- 本产品释放的蒸汽可能会造成烫伤，特别是熨烫至熨烫板边缘时。切勿将蒸汽直接对着人或动物。
- 熨斗必须使用和放置于稳固的表面上。当熨斗被放置于支架上时，应确保其表面平稳。
- 本产品设计仅供家庭使用，任何不当使用或因不符合本使用说明而引起的故障，本公司概不负责，且不在保修范围内。

可使用的水？

您的熨斗可直接使用未经处理的自来水，但必须定期使用自动清洗功能以清除蒸气室内的污物和水垢。如果当地的水质较硬（与当地水资源管理机构确认）请将水与蒸馏水或去除矿物质的水按如下比例配制使用：50% 未经处理的自来水；50% 蒸馏水或除去矿物质的水。

不可使用的水？

热力令水蒸发时，会把水中的物质浓缩。下列含有有机杂质或矿物质元素的水会导致滴漏、棕色污点或令熨斗提前损耗：干衣机的水、加入香剂的水、软化水、冰箱剩水、电池液、空调排水、蒸馏水、经过滤的水或雨水，不可使用以上列出的水。

自动断电保护（根据型号）

- 在以下情况下，电子安全系统会自动切断电源，自动断电保护指示灯将闪烁 —，**当自动断电保护指示灯亮时，温度指示灯灭。**
以保证您的安全：
- 熨斗竖放不动8分钟。
 - 熨斗平放或侧放不动30秒。
- 重新使用时，只需轻轻晃动熨斗，直到自动断电保护指示灯停止闪烁，即可恢复

环境



环保第一！

- ① 您所使用的机器含有多种可循环利用的材质。
- ② 请将废旧机器送至专门的废旧物品回收中心。

疑难问题处理

问题	可能造成的原因	解决方法
水从底板的蒸汽孔中流出	设定温度过低，不能形成有效蒸汽	将温度调节旋钮设定于蒸汽区域（从“**”到“最大MAX”）
	使用蒸汽效果时，熨斗未达到足够温度	待指示灯熄灭
	使用蒸汽喷射按钮频率过高。 蒸汽流量太高	每次按钮间应暂停数秒 减少蒸汽流量
	储藏熨斗时水平放置，水箱未倒空， 蒸汽控制滑键未设定于“0.0”位置	参见“储藏熨斗”部分
从蒸汽孔渗漏出褐色斑点污物并弄脏织物	使用了化学除垢剂	不要在水箱的水中注入任何除垢剂
	没有使用合适的水	使用自动清洗功能，参见“使用怎样的水”部分
	织物纤维残留于底板蒸汽孔中并被烧焦	使用自动清洗功能，并用湿海绵清洗底板。 时常用吸尘器清洁底板上的蒸汽孔
	织物未彻底洗净或未洗过新衣物	确保衣物彻底清洗，以去除肥皂或化学品残留。
底板变脏或发黄，弄脏衣物	使用了不适当的程序（温度设定过高）	如上指示清洁底板选择合适的程序
	使用熨衣服浆粉的方式错误	如上指示清洁底板将浆粉喷在熨烫衣物的背面
无蒸汽或蒸汽量少	水箱无水	注水于水箱
	防垢阀门脏	清洁防垢阀门
	熨斗积聚了水垢	清洁防垢阀门并进行自动清洗
	干式熨烫方式使用时间太久	进行自动清洗
底板刮花或损坏	熨斗被水平放置于金属物体的表面 或熨烫过程中碰到拉链	将熨斗竖直放置
当水箱注清水时，蒸汽或水从熨斗冒出	蒸汽控制滑键未设定于“0.0”位置	确认蒸汽控制滑键设定于“0.0”位置
	水箱注水过多	水位不能超过“MAX”位置
不能喷水	水箱水量不够	注水于水箱
使用熨斗时出现滴漏	拔出防钙阀门后注水。	注水时请不要拔出防钙阀门。

如有其他任何疑问或咨询，请联系我们的客户服务中心，
获取相关协助和建议。

