



**Effectis**  
**Effectis** Easy

## SUMMARY

Connection at first use.....	p. 5
Lock system.....	p. 5

### PREPARATION

What water may be used?.....	p. 6
Filling the water tank.....	p. 6
Switch the steam generator on.....	p. 7
Operating the control panel.....	p. 8

### USE

Steam ironing.....	p. 9
Steam boost function (depending on model).....	p. 9
Regulation Effectis Easy and ECO MIN MODE.....	p. 10
Regulation Effectis and ECO MODE.....	p. 11
Dry ironing.....	p. 13
Vertical steam ironing.....	p. 13
«AUTO-OFF» System.....	p. 13
Refilling the tank during use.....	p. 14

### MAINTENANCE AND CLEANING

Cleaning your steam generator.....	p. 16
Rinsing the boiler, once a month.....	p. 17
Storing the steam generator.....	p. 19

### PROBLEMS WITH YOUR STEAM GENERATOR?

Problems, possible causes, solutions.....	p. 20
---	-------

## Description

1. Steam Boost button (depending on model)
2. Steam Output button
3. Iron lights EFFECTIS / EFFECTIS EASY
4. Steam cord
5. Control panel
  - a. « ECO min » button with light
  - b. « ON-OFF » button with light
  - c. « Anti Calc » light
  - d. « OK » button
  - e. « Water tank empty » light
6. Steam cord storage
7. Power cord storage
8. Anti calc rinsing
9. Boiler (in the base unit)
10. Water tank filler cover
11. Ultraglide Soleplate
12. Locking system (depending on model)
13. Temperature control dial for iron soleplate (depending on model)

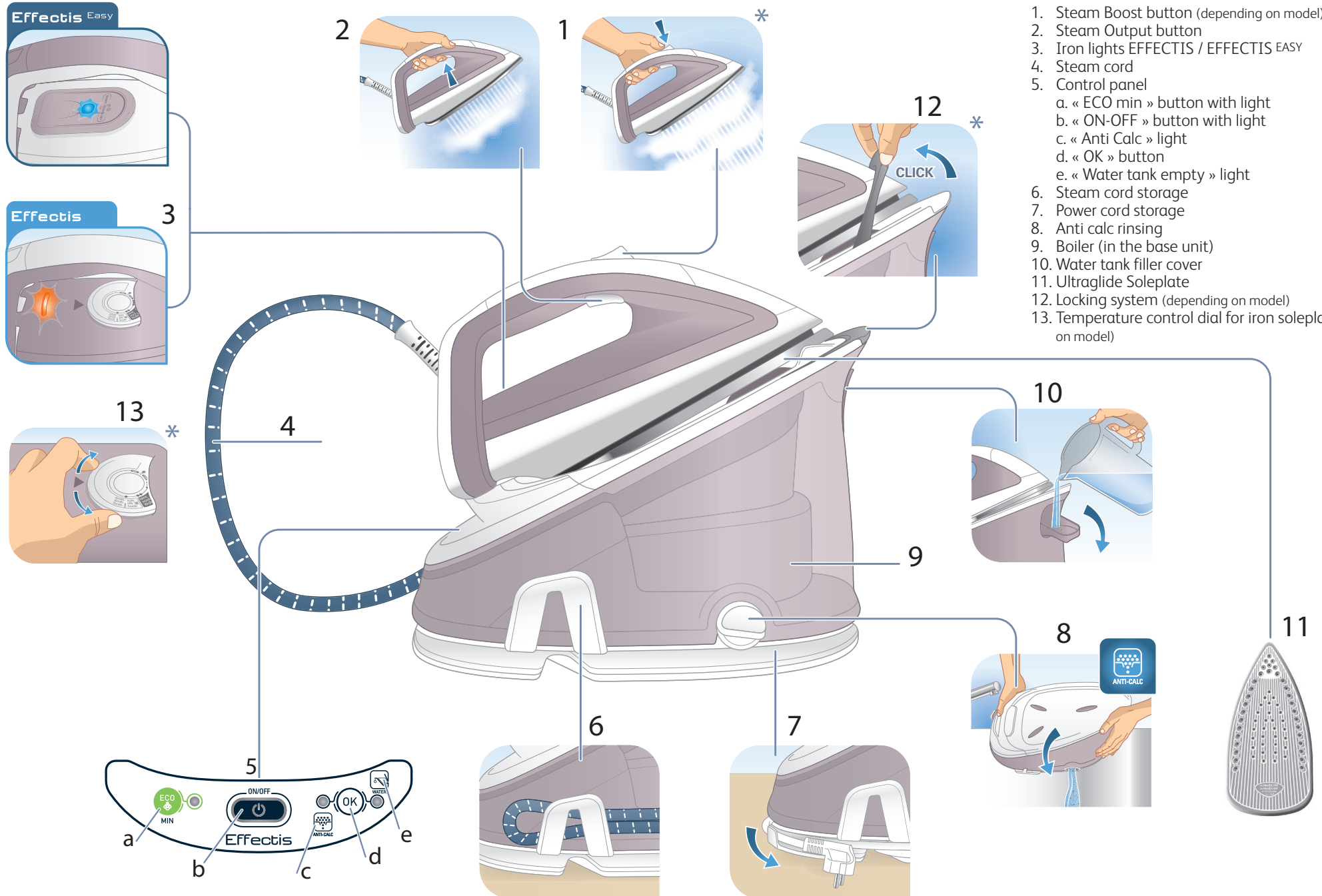

## CONNECTION AT FIRST USE

- Remove the product from its packaging
- and recover the cord.
- Tilt the product base and plug the cable into the connector.

## Locking system for retaining the iron on the base

Your steam generator is fitted with a retaining hoop to hold the iron onto the base with a locked position for easy transport and storage:

- Locking
- Unlocking

To transport your steam generator using the handle of the iron:

- Put the iron on the steam generator iron rest and raise the retaining hoop over the iron until it locks into place (audible click).
- Hold the iron by the handle to transport your steam generator.

## PREPARATION

### What water may be used?

#### • Tap water:

Your appliance has been designed to use tap water. If your water is very hard, mix 50 % tap water and 50 % bottled demineralised water. In some coastal areas, the salt content of the water may be high. In such cases, use only demineralised water.

• **Water softener:** There are several types of water softeners available and most of them can be used in the generator.

However, some softeners (especially those that use chemicals such as salt) may cause white or brown streaks. This is often the case when using water from filtering jugs. If you experience this sort of problem, we suggest you try using untreated tap water or bottled water.

• **NB:** Never use rain water or water containing additives (such as starch, fragrances or water from household appliances).

These additives may affect the properties of the steam, and together with high temperatures can cause deposits to form in the steam chamber which could soil your laundry.

### Filling the water tank

- Place your steam generator on a stable, flat heat-resistant surface.
- We recommend that you use a mesh type ironing board to allow steam to pass through the garments for better ironing results and also to prevent steam venting sideways.
- Check that your appliance is unplugged and open the flap on the tank.
- Put in untreated tap water up to the max mark.

## Switch the steam generator on

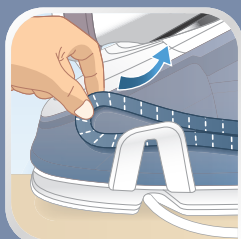
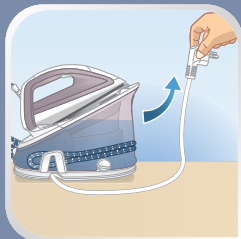

**The first time the appliance is used, there may be some fumes and smell but this is not harmful. They will not affect use and will disappear rapidly.**

- Put the steam generator on a flat, stable, horizontal surface that is heatproof.
- Always ensure that the base unit is positioned close enough to the ironing surface to avoid straining and wear of the steam cord.
- Completely unwind the power cord and take the steam cord out of its storage space.
- Plug your steam generator into an earthed socket.
- Press the «ON-OFF» button.
- The «ON-OFF» button light remains flashing while the appliance is warming up. When the light stops flashing (after approximately 2 minutes) the steam generator is ready.

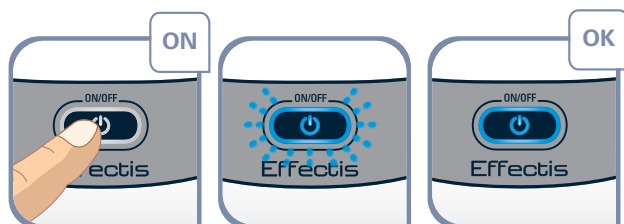

## Operating the control panel

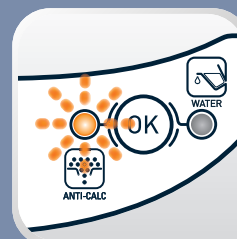

- The blue light of the «ON-OFF» button is flashing : the boiler is heating up. When the light stops flashing, the steam generator is ready.
- The red «Water tank empty» button light is flashing : the water tank is empty. See paragraph «Refilling the water tank during use»
- The orange «Anti-calc» light is flashing : maintenance is required, see paragraph «Maintenance and cleaning».
- Your steam generator comes with an automatic shut-off system after approximately 8 minutes without use. The «ON-OFF» button light is flashing: the steam generator is on standby. Press the «ON-OFF» button or the steam output button to start ironing again. See paragraph «AUTO-OFF» System.

## USE

### Steam ironing

**Recommendations:** To prime the steam circuit, either before using the iron for the first time, or if you have not used the steam function for a few minutes, press the steam control button several times in a row, holding the iron away from your clothes. This will enable any cold water to be removed from the steam circuit.



- To obtain steam, press the steam output button under the iron handle. The steam will stop when you release the button.
- After approximately one minute, and regularly while it is being used, your steam generator's electric pump injects water into the boiler. It makes a noise but this is quite normal.
- If you are using starch, always spray it onto the reverse side of the fabric to be ironed.

**Do not iron over zips, studs or other hard or sharp objects which may damage the soleplate. Do not place the iron on a metal support. When taking a break from ironing, always place the iron on the iron rest plate of the unit. It is equipped with non-slip pads and has been designed to withstand high temperatures.**

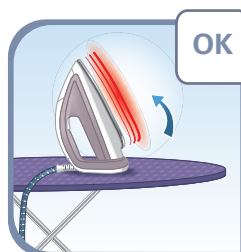



### Steam boost function (depending on model)

- Your appliance is fitted with a steam boost function: automatic sequential steam for effortless use.
- To use this function, press the steam boost button on the top of the iron.

### Regulation

#### EFFECTIS<sup>EASY</sup> (depending on model)

- Your steam generator is fitted with SMART TECHNOLOGY EASY electronic regulation which offers you the optimum temperature and steam combination allowing you to iron all your ironable fabrics without risk and without having to sort them.

Settings	Recommended use	Labelling	Examples
	Optimum for all types of ironable fabrics without any risk of burning.		Cotton, wool**, silk, polyester, cashmere, mohair, viscose and synthetic/cotton mixes, linen and mixed fibres.

**Warning, fabrics with the symbol  are not suitable for ironing.**



- **ECO MIN MODE:** The ECOmin function reduces energy consumption. Press the ECO button to change to ECO mode and press the same button again to exit this mode. The ECO /Min function allows ironing at the lowest temperature and low steam flow suitable for ironing the most delicate fabrics.

\*\*If you are ironing woolen garments, press repeatedly on the steam shot button without placing the iron on the garment. This will avoid it becoming shiny.



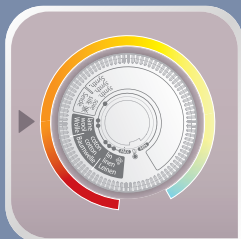

OK

## Regulation

EFFECTIS (depending on model)

- Your steam generator is fitted with an iron temperature control dial.
- Place the iron's temperature control dial according to the type of fabric to be ironed (see table below).

SETTING THE TEMPERATURE AND STEAM OUTPUT ACCORDING TO TYPE OF FABRIC TO BE IRONED

TYPE OF FABRICS	SETTING TEMPERATURE CONTROL	
Synthetics, Silk ( polyester, acetate, acrylic, polyamide)	●	
Wool**, Viscose	● ●	
Linen, Cotton	● ● ●	

**Warning, fabrics with the symbol  are not suitable for ironing.**

### EFFECTIS Iron temperature setting:

- Start with the fabrics to be ironed at a low temperature (●) and finish with those which need higher temperatures (●●● or Max).
- Mixed fibre fabric: set the ironing temperature to the setting for the most delicate fabric.
- If you put the temperature control dial in the “min” position, the iron does not become hot.

\*\*If you are ironing woolen garments, press repeatedly on the steam shot button without placing the iron on the garment. This will avoid it becoming shiny.

**Important: whenever you start using your iron and whenever you reduce the temperature during use, the iron is fully ready for use when its iron light goes out. During use, when you increase the temperature of the iron, you can start ironing immediately.**

- While ironing, the iron light turn on and off, as the temperature adjusts without interrupting ironing.
- If you are in doubt about the type of fabric an item of clothing is made from, check the label.

\*\*If you are ironing woolen garments, press repeatedly on the steam shot button without placing the iron on the garment. This will avoid it becoming shiny.



**ECO MODE:** Your steam generator iron has an ECO mode function which uses less power whilst still guaranteeing a sufficient steam flow for you to iron your garments properly. In order to use this function, once the Temperature control dial has been correctly set (see table above), press on the ECO mode button located on the control panel. The ECO mode can be used on all types of fabrics, nevertheless for very thick or very creased fabrics, we recommend that you use the normal steam flow for best results.



## Dry ironing

- Do not press the steam output button under the iron handle.

## Vertical steam ironing

**Recommendations: for fabrics other than linen or cotton, hold the iron a few centimetres from the garment to avoid burning the fabric.**

- Hang the garment on a coat hanger and hold the fabric slightly taut with one hand.
- As steam is very hot: never attempt to remove creases from a garment while it is being worn, always hang garments on a coat hanger.
- Holding the iron in a vertical position tilted slightly forwards, press repeatedly on the steam control button (underneath the iron handle) moving the iron from top to bottom.

## «AUTO-OFF» System

- For your safety, the steam generator is fitted with an «AUTO-OFF» monitoring system, which is activated automatically after approximately 8 minutes without use.
- Only the «ON-OFF» button flashes to indicate that the appliance is on standby.

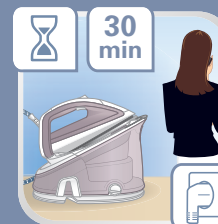
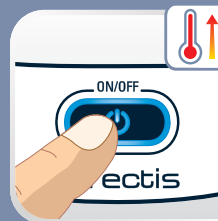
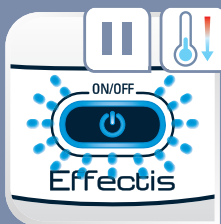

- To reactivate the steam generator:
  - Press the «ON-OFF» button.
  - Wait for the «ON-OFF» button light to stop flashing before starting your ironing again.
- For your safety, after approximately 30 minutes of non-use, the «AUTO-OFF» system switches off your steam generator. To start your ironing again, press the «ON-OFF» button.

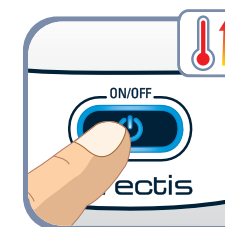
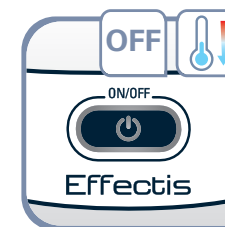

## Refilling the tank during use

- When the red «water tank empty» light is flashing, there is no more steam. The water tank is empty.
- Switch off and unplug the product



- Open the water tank filler cover.

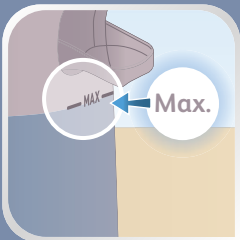

- Using a jug of water, fill to a maximum of 1.5 litre with untreated tap water and fill the tank, making sure not to exceed the «Max» level of the tank.



- Close the water tank filler cover.



- Plug the appliance and turn it on.



- Press the «OK» restart button under the control panel to continue ironing. When the «ON-OFF» button light remains on, the steam is ready.

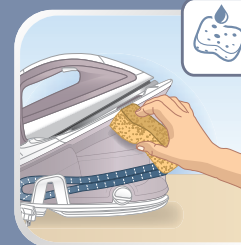

## MAINTENANCE AND CLEANING

### Cleaning your steam generator

Before cleaning, ensure your steam generator is unplugged and that the soleplate and the iron have cooled down.

- Do not use detergent or descaling products for cleaning the soleplate base-unit.
- Never hold the iron or the base unit under the tap.
- Regularly clean the soleplate with a damp, nonmetallic washing up pad.
- Clean the plastic parts of the appliance occasionally with a soft cloth.



## Rinsing the boiler, once a month

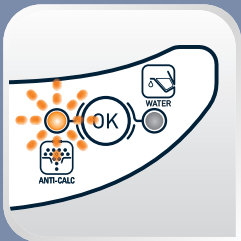

**Before cleaning, ensure your steam generator is unplugged and that the soleplate and the iron have cooled down.**

- To extend the efficient operating life of your boiler and avoid scale particles on your linen, your generator is equipped with an orange anticalc light that flashes on the control panel after about 10 uses.

If the orange anticalc light flashes, you can continue ironing normally but remember to rinse the boiler first the next time that you use it.

**Before proceeding, check that the generator is cool and unplugged for more than 2 hours.**

- Place the steam generator on the edge of your sink, with the iron placed to one side, standing on its heel.
- Gently unscrew the boiler rinse cap.
- Holding the steam generator in a tilted position, using a jug and a funnel, fill the boiler with  $\frac{1}{4}$  litre of untreated tap water.
- Shake the base unit for a few moments and then empty it completely into your sink.



- To obtain the best results, we recommend that this operation is done twice.

- Screw back and tighten up the boiler rinse cap.

**The next time you use the generator hold down the "OK" button for a few seconds to turn off the orange light.**

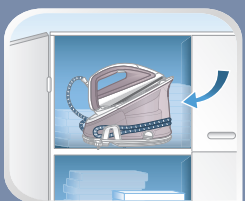
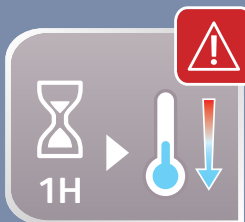
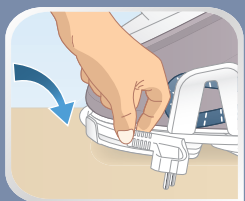
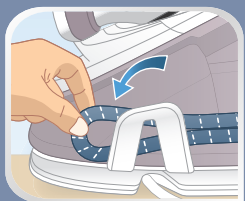
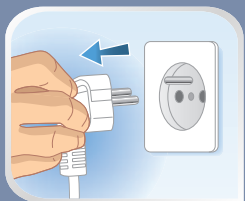

## Storing the steam generator

- Place the iron on the steam generator iron rest.
- Switch your steam generator off by pressing the «ON-OFF» button and unplug the appliance.
- Raise the retaining hoop over the iron until the protection system locks into place (audible click) – depending on model.
- Store the electrical lead in its housing.
- Store the steam cord away in its compartment.
- Leave the steam generator to cool before putting it away if you are storing it in a cupboard or a confined space.
- You can store your steam generator safely by carrying it by the iron handle.
- If you store your steam generator in a relatively cold place (approximately <10°C), put it in a warm place before starting your ironing.
- Wait 3 hours for the iron to reach room temperature.

## PROBLEMS WITH YOUR STEAM GENERATOR?

PROBLEMS	CAUSES	SOLUTIONS
The steam generator does not switch on or the iron indicator light and the «ON-OFF» light are not lit up.	The appliance is not switched on.	Check that the appliance is plugged in correctly to a working power socket and that it is switched on. Press the «ON-OFF» button.
	The «AUTO-OFF» system has activated after 30 minutes of non-use and has switched off your steam generator.	Press the «ON-OFF» restart button located under the control panel.
Water runs out of the holes in the soleplate.	The soleplate is not hot enough.	Wait for the thermostat light to stop flashing before activating the steam control.
	The water has condensed in the pipes because you are using steam for the first time or you have not used it for a few minutes.	Press the steam button while holding your iron away from the ironing board until the steam starts to come out.
Water streaks appear on the linen.	Your ironing board cover is soaked with water as it is not suited to the power of a steam generator.	Ensure that you have a suitable (vented mesh) ironing board).
White streaks come through the holes in the soleplate.	Scale is coming out of the boiler because it is not being rinsed regularly.	Rinse the boiler (see § descaling your steam generator).
Brown streaks come through the holes in the soleplate and stain the linen.	You are using chemical descaling agents or additives in the water for ironing.	Never add any products to the water tank (see § What water can I use?).
	Your linen is not rinsed sufficiently or you have ironed a new garment before washing it.	Ensure linen is rinsed thoroughly to remove any soap deposits or chemicals on new garments which may be sucked up by the iron.
The soleplate is dirty or brown and may stain the linen.	You are using starch.	Always spray starch on the reverse side of the fabric to be ironed.
There is no steam or there is little steam.	The water tank is empty (red warning light flashing).	Fill the water tank and press the «OK» until the light goes out.
The red «tank empty» button is flashing even though the tank has been filled.	You have not pressed the «OK» restart button.	Press the «OK» restart button on the control panel.
Steam comes out around the boiler rinse cap.	The boiler rinse cap is not tightened correctly.	Tighten the boiler rinse cap but do not overtighten it.
	The boiler rinse cap seal is damaged.	Contact an Approved Service Centre.
Steam or water is coming out from under the appliance.	The appliance is faulty.	Stop using the steam generator and contact an Approved Service Centre.
The «Anti-scale» button is flashing even though the boiler has been rinsed.	You have not pressed the «OK» restart button.	Press the «OK» restart button located on the control panel.
The soleplate is scratched or damaged.	You have put your iron down on a metal iron rest or you have ironed over a zip or metal fastener.	Always stand the iron upright or on the iron rest. Do not iron over a zip or metal fastener.
	You have cleaned your soleplate with an abrasive or metal pad.	See chapter «Cleaning the soleplate».
The red «tank empty» light is flashing and the «ON-OFF» button does not work.	The appliance has been stored in a cold place (approximately <10°C).	Unplug the appliance. Wait 3 hours for the appliance to reach room temperature.

If you have any problems or queries please call our Customer Relations team first for expert help and advice: All the contacts are available in the international warranty