

# Tefal®

## OptiGrill™ Smart

FR  
NL  
DE  
EN  
IT  
ES  
PT  
EL



### Compatibility:



iPhone 4S or newer model,  
iPad 3 / iPad mini  
or newer model.



Android™ 4.3 or newer.

Apple, the Apple logo, iPhone, and iPad are trademarks of Apple Inc., registered in the U.S. and other countries. App Store is a service mark of Apple Inc. Android, Google Play and the Google Play logo are trademarks of Google Inc.

**Mode d'emploi - Instructies voor gebruik**  
**Bedienungsanleitung - Instructions for use - Istruzioni d'uso**  
**Instrucciones de uso - Manual de instruções - Οδηγίες χρήσης**

# SAFETY INSTRUCTIONS

## IMPORTANT SAFEGUARDS

**Use, maintenance and installation of this product: for your safety, please refer to the various sections of this manual and the corresponding diagrams.**

- This appliance is not intended to be operated using an external timer or separate remote control system, other than those specified by the manufacturer, such as a smartphone or tablet.
- This appliance is intended for indoor, domestic household use only. It is not intended to be used in the following applications, and the guarantee will not apply for:
  - staff kitchen areas in shops, offices and other working environments;
  - farm houses;
  - by clients in hotels, motels and other residential type environments;
  - bed and breakfast type environments.
- Before first use remove all packaging materials, stickers and accessories from the inside and the outside of the appliance.
- This appliance is not intended for use by persons (including children) with reduced physical, sensory or mental capabilities, or lack of experience and knowledge, unless they have been given supervision or instruction concerning use of the appliance by an adult responsible for their safety. Children should be supervised to ensure that they do not play with the appliance, and do not use as a toy.
- This appliance can be used by children aged from 8 years and above and persons with reduced physical, sensory or mental capabilities or lack of experience and knowledge if they have been given supervision or instruction concerning use of the appliance in a safe way and understand the hazards involved. Cleaning and user maintenance shall not be made by children unless they are older than 8 and supervised.
- Keep the appliance and its cord out of reach of children less than 8 years.

- Never leave the appliance unattended when in use.
-  Accessible surface temperatures can be high when the appliance is operating. Never touch the hot surfaces of the appliance.
- This appliance is not intended to be operated by means of an external timer or separate remote-control system.
- Fully unwind the power cord before plug the appliance.
- If the power supply cord is damaged, it must be replaced by the manufacturer or its after sales service in order to avoid any danger.
- Do not use an extension lead. If an extension cord is used, make sure to choose one of equivalent diameter with an earthed socket and is suited to the power rating of the appliance. Take all necessary precautions to prevent anyone tripping over an extension cord.
- Always plug the appliance into an earthed socket.
- Make sure that the electric power supply is compatible with the power rating and voltage indicated on the bottom of the appliance.
- Use a sponge, hot water and washing up liquid to clean the cooking plates.
- Never immerse the appliance, its power cord or plug in water or any other liquid.

**WARNING:** Do not heat or preheat without the 2 cooking plates inside the grill.

## Do

- Read the instructions carefully, common to different versions depending on the accessories supplied with your appliance, and keep them within reach.
- If an accident occurs, rinse the burn immediately with cold water and call a doctor if necessary.
- Before first use, wash the plates (see paragraph 5), pour a little cooking oil onto the plates and wipe with a soft cloth or paper kitchen towel.
- Position the power cord carefully, whether an extension is used or not, so that guests can move freely around the table without tripping over it.
- Cooking fumes may be dangerous for animals which have a particularly sensitive respiratory system, such as birds. We advise bird owners to keep them away from the cooking area.
- Always keep the appliance out of the reach of children.
- Check that both faces of the plate are clean before use.
- To prevent damage to the plates, only use them on the appliance for which they were designed (e.g., do not place in an oven, on the gas ring or electric hot-plate, etc.).
- Ensure that the plates are stable, well positioned and correctly clipped to the appliance. Only use the plates provided with the appliance or bought from an Approved Service Centre.
- Always use a wooden or plastic spatula to avoid damaging the cooking plates.
- Only use parts or accessories provided with the appliance or bought from an Approved Service Centre. Do not use them for other appliances or intention.

# Do not

- Do not use the appliance outside.
- Never leave the appliance unattended when plugged in or in use.
- To prevent the appliance from overheating, do not place it in a corner or below a wall cupboard.
- Never place the appliance directly on a fragile surface (glass table, tablecloth, varnished furniture, etc.) or on a soft surface such as a tea-towel.
- Never place the appliance under a cupboard attached to a wall or a shelf or next to inflammable materials such as blinds, curtains or wall hangings.
- Never place the appliance on or near hot or slippery surfaces; the power cord must never be close to or in contact with hot parts of the appliance, close to a source of heat or resting on sharp edges.
- Do not place cooking utensils on the cooking surfaces of the appliance.
- Never cut food directly on the plates,
- Do not use metal scouring pads, abrasive wire wool or harsh scouring powder as this may damage the nonstick coating.
- Do not move the appliance when in use.
- Do not carry the appliance by the handle or metallic wires.
- Never run the appliance empty.
- Do not use aluminium foil or other objects between the plate and the food being cooked.
- Do not remove the grease collection tray while cooking. If the grease collection tray becomes full when cooking: let the appliance cool down before emptying.
- Do not place the hot plate on a fragile surface or under water.
- To preserve the non-stick properties of the coating, avoid excessive preheating with the appliance empty.
- The plates should never be handled when hot.
- Do not cook food in aluminium foil.
- To avoid spoiling your appliance, do not use flambé recipes in connection with it at any time.
- Do not place a sheet of aluminum or any other object between the plates and the heating element.
- Never heat or cook whilst the grill is open.
- Never heat up the appliance without the cooking plates.

## Tips/information

- Thank you for buying this appliance, which is intended for domestic use only.
- For your safety, this appliance complies with the applicable standards and regulations - Low voltage directive - Electromagnetic compatibility - The environment - Materials in contact with food.
- On first use, there may be a slight odour and a little smoke during the first few minutes.
- Our company has an ongoing policy of research and development and may modify these products without prior notice.
- Do not consume foodstuff that comes into contact with the parts marked with logo .
- If the food is too thick, the safety system will stop the appliance from working.

## Environment



### Environment protection first!

- ① Your appliance contains valuable materials which can be recovered or recycled.
- ② Leave it at a local civic waste collection point.





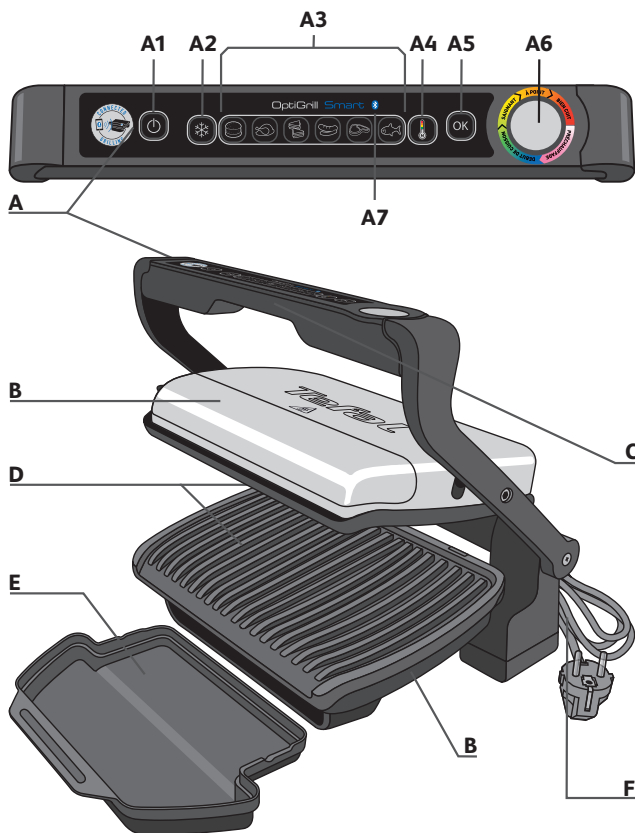

## Description

- |                            |  |                         |
|----------------------------|--|-------------------------|
| <b>A</b> Control panel     | <b>A4</b> 4 temperature settings in manual mode; see specific manual mode in Quick Start Guide | <b>B</b> Body           |
| <b>A1</b> On/off button    | <b>A5</b> “OK” button  | <b>C</b> Handle         |
| <b>A2</b> Frozen food mode | <b>A6</b> Cooking level indicator  | <b>D</b> Cooking plates |
| <b>A3</b> Cooking programs | <b>A7</b> Bluetooth light  | <b>E</b> Drip tray      |
|                            |  | <b>F</b> Power cord     |

# Preparing

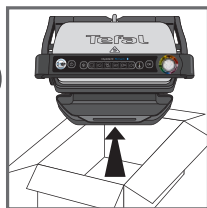

1



2

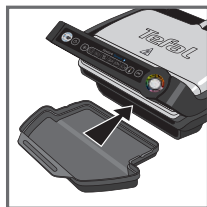

3



4

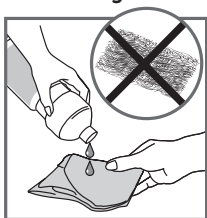

5



6

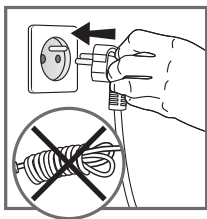

7

- 1 Remove all packaging materials, stickers and accessories from the inside and the outside of the appliance.  
The colour sticker on the cooking level indicator can be changed, according to the language. You can replace it with the one on the inside of the packaging.
- 2 Before using for the first time, thoroughly clean the plates with warm water and a little dishwashing liquid, rinse and dry thoroughly.
- 3-4 Position the removable drip tray at the front of the appliance.
- 5 For the best results you may wipe the cooking plates using a paper towel dipped in a little cooking oil, to improve the non-stick release.
- 6 Remove any surplus oil using a clean kitchen paper towel.
- 7 Make sure that the upper and lower plates are correctly positioned in the product. Do not activate preheating without the plates. Plug your appliance into the mains power supply. (Note that the cord should be completely extended).

# Cooking with connection



## 1 Download the application and pair your OptiGrill



1-2

- 1 Download the My OptiGrill app from the App Store or Play Store for Android™ via your tablet or smartphone. Activate the Bluetooth® function on your tablet or smartphone. Plug in your OptiGrill Smart and turn it on by pressing the on/off button.
- 2 Select your OptiGrill Smart and follow the instructions on the application to pair your OptiGrill.

**NB:** To pair your OptiGrill Smart, keep pressing a few seconds the button "OK". The Bluetooth led blinks during the pairing phase and then becomes fixed once paired.



3

- 3 Create your account and enjoy My OptiGrill App.

See p.64 how to create and use your custom profiles

## 2 Start cooking...

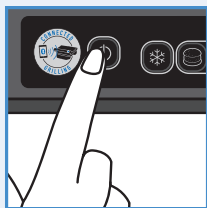

4

- 4 Press the on/off button.

**Caution:** Make sure there is no food between the plates

EN

with connection

## 2 ...Preheating



5

- 5 To start preheating, open the app's dashboard.

The Bluetooth indicator on the product is fixed when it is connected to the appliance. It is switched off in disconnected mode.



6

- 6 Choose a cooking program on the app's dashboard and click "OK" on the OptiGrill's button.

The "OK" button lights blue in connected mode.

**Caution:** Make sure there is no food between the plates.

If the food you wish to cook is frozen, press the corresponding button.



7

- 7 After clicking "OK", preheating starts. The application notifies you the preheating is finished and emits a "bip".

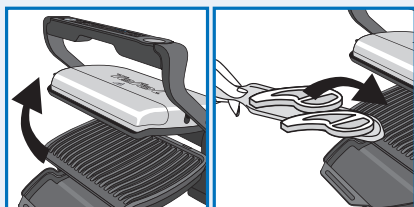

8

9



10

**8-9** After preheating, the appliance is ready for use.

Open the grill and place the food on the cooking plate.

**Comments:** if the appliance remains open for too long, the safety system will turn off the appliance automatically.

**10** The OptiGrill's app. indicates that the cooking has started then wait until the desired cooking level.

See step 14 to personalize your cooking preferences with custom profiles.



11

12

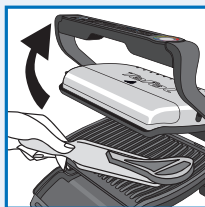

13

**11-12-13** If you want to cook food to different personal tastes, open the grill and remove the food when it has reached the desired level and then close the grill and continue cooking the other food. The program will continue its cooking cycle until it reaches the 'well done' level.

EN

with connection



## Create your custom profiles



Create a new profile by choosing a picture, a sound, a category and by completing your preferences.

## Cook with your custom profiles



- 14 Set a customized cooking by selecting a cooking mode and place the profiles at the desired cooking levels. Press the profile to position it on the wheel. Then move by dragging it with your finger. Adding and position can be changed at any time. Press “OK” on your OptiGrill to start preheating. Follow the steps on the application to start the cooking process.



14

**Note for very thin pieces of food:** close the appliance, the button “OK” will flash and the indicator will stay “fixed purple”, press “OK” to ensure the appliance recognizes the food and that the cooking cycle starts.

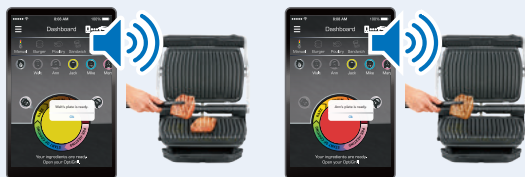

15

### 15 Monitor your customized cooking:

The application rings when a cooking profile is reached. Take your portion out of the OptiGrill and close the lid to continue cooking.



16

#### 16 Keep warm function

Once the well done cooking level is reached, the cooking is finished, the appliance automatically activates the keep warm function, the indicator light turns red and the device begins to beep every 20 seconds. If food is left on the grill, it will continue to cook while the cooking plates cool. You may deactivate the beep by pressing the button "OK".

**Note:** the security system will power off the appliance automatically after a certain period of time.

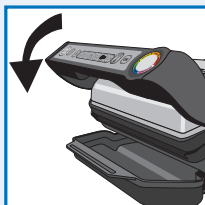

17

17 Close the appliance. The control panel will light up and set itself to 'choice of program' mode.

**Comment:** the security system will turn off automatically if no program selection is made.

## Successive cooking

If you wish to cook larger quantities, set in temperature the appliance again (see section 2. "Preheating", starting from point 4), even if cooking the same type of food or same programme.

### Cooking larger quantities of food:

Once your first batch of food has finished cooking:

1. Make sure that the appliance is closed and no remnants of food remain inside.
2. Select the correct cooking mode or programme (this step is necessary even if the cooking mode is the same as for the foods you have just finished cooking).
3. Press the button "OK" to begin preheating. While preheating, the light indicating the level of cooking will blink purple.
4. Once preheating is complete, the appliance will beep and the indicator light will stop blinking purple.
5. The appliance is ready to be used once preheating is complete.  
Open the grill lid and place the food inside the appliance.

### Important:

- Please note that preheating is required for each new cooking of food.  
Reminder: before activating preheating, make sure that the appliance is closed and no remnants of food remain inside.
- Then wait for preheating to finish before opening the grill and placing food inside.

**Note :** if the new preheating cycle is activated immediately after the end of the preceding cycle, the preheating time will be reduced.

# Cooking without connection



## 1 Start cooking with your OptiGrill

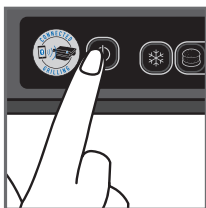

1

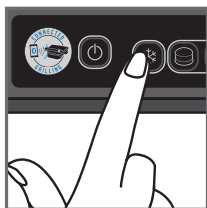

2

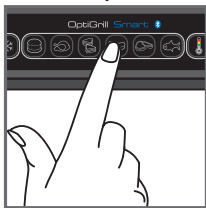

3

## 2 Preheating

If you are uncertain about what cooking mode to use, please refer to the cooking guides page 73.



4

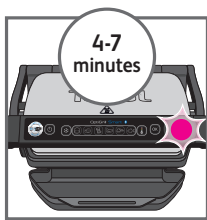

5



6

- 1 Press the on/off button.

**Caution :** Make sure there are no food between the plates

- 2 If the food you wish to cook is frozen, press the corresponding button.
- 3 Select the appropriate cooking mode according to what type of food you wish to cook.

**Tip, especially for meat:** the cooking results on the preset programs may vary depending on origin, cut and quality of the food being cooked, the programs have been set and tested for good quality food.

Similarly, the thickness of the meat must be taken into account during cooking; you should not cook foods with a thickness greater than 4 cm.

- 4 **Press the "OK" button:** the appliance starts preheating and the cooking level indicator flashes purple.

The "OK" button lights red in disconnected mode.

**NB:** If you have selected the wrong program, return to stage 1.

- 5 Wait for 4-7 minutes.
- 6 An audible tone is heard and the cooking level indicator stops flashing purple when pre-heating is complete.

**Comments:** At the end of preheating, if the appliance remains closed, the safety system will turn off the appliance.



### 3 Cooking...

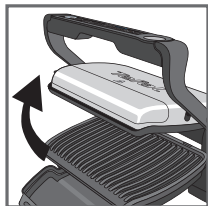

7

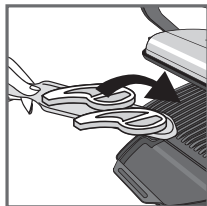

8



9

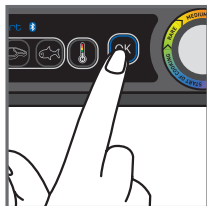

10

**7-8** After preheating, the appliance is ready for use.

Open the grill and place the food on the cooking plate.

**Comments:** if the appliance remains open for too long, the safety system will turn off the appliance automatically.

**9-10** The appliance automatically adjusts the cooking cycle (time and temperature) according to the food thickness and quantity.

Close the appliance to start the cooking cycle.

**Note for very thin pieces of food:** close the appliance, the button "OK" will flash and the indicator will stay "fixed purple", press "OK" to ensure the appliance recognizes the food and that the cooking cycle starts.

The cooking level indicator turns blue and then becomes green to indicate the cooking is in progress (for the best results do not open or move your food during the cooking process).

While cooking is in progress, a beep alerts the user each time a certain level of cooking is attained (e.g. rare/yellow).

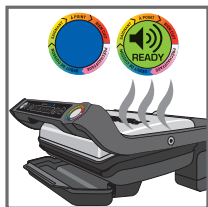

11

**11** According to the degree of cooking, the indicator light changes color. When the indicator light is yellow with a beep, your food is rare, when the indicator light is orange with a beep, your food is medium and when the indicator light is red, your food is well done.

**N.B.:** if you like your meat very rare, remove the meat when the cooking level indicator turns green.

Please note, especially on meat, it is normal that cooking result vary depending on type, quality and origin of food.

EN

without connection

### 3 ...Cooking



12

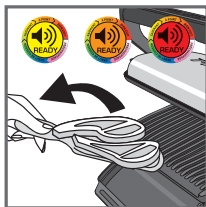

13

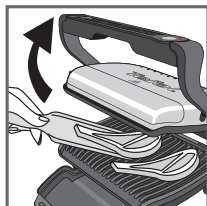

14

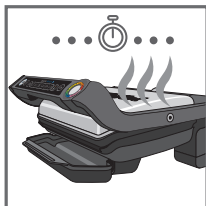

15

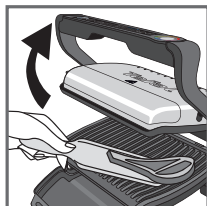

16



17

**12-13** When the color corresponding to your choice of cooking level appears and that the beep sounds, open the appliance and remove your food.

**14-15-16** If you want to cook food to different personal tastes, open the grill and remove the food when it has reached the desired level and then close the grill and continue cooking the other food. The program will continue its cooking cycle until it reaches the 'well done' level.

#### 17 Keep warm function

Once the well done cooking is reached, the cooking is finished, the appliance automatically activates the keep warm function, the indicator light turns red and the device begins to beep every 20 seconds. If food is left on the grill, it will continue to cook while the cooking plates cool. You may deactivate the beep by pressing the button "OK".

**Note :** the security system will power off the appliance automatically after a certain period of time



18

- 18 Close the appliance. The control panel will light up and set itself to 'choice of program' mode.

**Comment:** the security system will turn off automatically if no program selection is made.

## Successive cooking

If you wish to cook larger quantities, set in temperature the appliance again (see section 2. "Preheating", starting from point 4), even if cooking the same type of food or same programme.

### Cooking larger quantities of food:

Once your first batch of food has finished cooking:

1. Make sure that the appliance is closed and no remnants of food remain inside.
2. Select the correct cooking mode or programme (this step is necessary even if the cooking mode is the same as for the foods you have just finished cooking).
3. Press the button "**OK**" to begin preheating. While preheating, the light indicating the level of cooking will blink purple.
4. Once preheating is complete, the appliance will beep and the indicator light will stop blinking purple.
5. The appliance is ready to be used once preheating is complete.  
Open the grill lid and place the food inside the appliance.

### Important:

- Please note that preheating is required for each new cooking of food.  
Reminder: before activating preheating, make sure that the appliance is closed and no remnants of food remain inside.
- Then wait for preheating to finish before opening the grill and placing food inside.

**Note :** if the new preheating cycle is activated immediately after the end of the preceding cycle, the preheating time will be reduced.



1

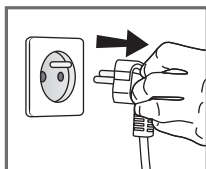

2

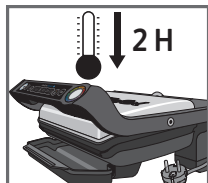

3

- 1 Press the on/off button to turn off the appliance.
- 2 Unplug the appliance from wall outlet.
- 3 Allow to cool for at least 2 hours.  
To avoid accidental burns, allow grill to cool thoroughly before cleaning.

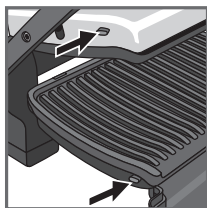

4

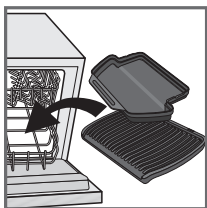

5

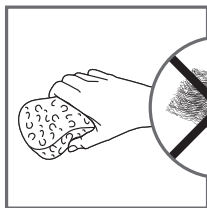

6

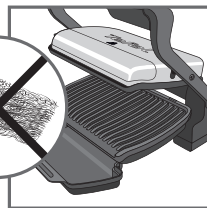

7

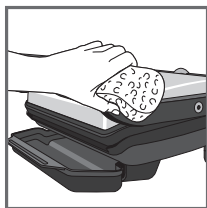

8

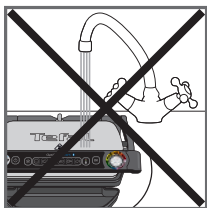

9

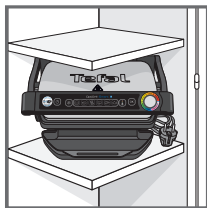

10

- 4 Before cleaning, unlock and remove the plates to prevent damage to the cooking surface.
- 5 The appliance and its cord cannot be placed in the dishwasher. The heating elements, visible and accessible parts, should not be cleaned after removing the plates. If they are very dirty, wait until the appliance has completely cooled down and clean them with a dry cloth.

6-7

If you do not wish to wash the cooking plates in the dishwasher, use hot water and a little washing up liquid to clean, then rinse thoroughly to remove any residue. Wipe them carefully with a paper towel.

















Do not use metal scouring pads, steel wool or abrasive cleaners to clean any part of the grill, use only nylon or non-metallic cleaning pads.

Drain the juice drip tray and wash it in mild soapy water, then dry thoroughly with a paper towel.









- 8 To clean the grill cover, wipe with a warm, wet sponge and dry with a soft, dry cloth.
- 9 Do not immerse the body of grill in water or any other liquid.
- 10 Always make sure grill is clean and dry before storing.

Any repairs must be carried out by an approved service representative.

# Troubleshooting guide

























Problem	Cause	Solution
Button  <b>blinking</b> +  Indicator light <b>solid green</b> + Button  <b>blinking</b>	<ul style="list-style-type: none"> <li>Switching on the appliance or starting an automatic cooking cycle with food and without plates preheating (manual mode is automatically activated).</li> </ul>	<ul style="list-style-type: none"> <li>2 possible options:               <ul style="list-style-type: none"> <li>Choose the temperature setting by pressing the  button and then press <b>OK</b>. Allow to cook, but you must monitor the cooking (manual mode).</li> <li>stop the appliance, remove the food, close the appliance properly, re-program the appliance and wait until end of preheating.</li> </ul> </li> </ul>
The appliance stops during the cycle of preheating or cooking.	<ul style="list-style-type: none"> <li>The appliance has been kept open for too long while cooking.</li> <li>The appliance has been idle too long after the end of warm up or keep warm.</li> </ul>	<ul style="list-style-type: none"> <li>Disconnect the appliance from the outlet and leave for 2-3 mins., restart the process. The next time you use the appliance, make sure you open and close it quick for best cooking results. If the problem occurs again contact your local Tefal customer service.</li> </ul>
 The indicator light <b>will blink white</b> + Button  /  /  /  <b>blinking</b> + Intermittent beeping The device does not beep.	<ul style="list-style-type: none"> <li>Appliance failure.</li> <li>Appliance stored or used in a room that is too cold.</li> </ul>	<ul style="list-style-type: none"> <li>Disconnect and reconnect your appliance and immediately restart a preheat cycle. If the problem persists, contact your Customer Service.</li> </ul>
 The indicator light <b>will blink white</b> + Button  <b>blinking</b> + Continuous beeping	<ul style="list-style-type: none"> <li>Appliance failure.</li> </ul>	<ul style="list-style-type: none"> <li>Unplug the appliance and contact customer service.</li> </ul>
After preheating, I placed the food inside and closed the appliance,  but the indicator light stays purple and cooking does not begin.	<ul style="list-style-type: none"> <li>The quantity of food inside the appliance is greater than 4 cm.</li> <li>The grill was not opened completely when placing the food inside.</li> <li>The appliance does not detect food inside <b>The quantity of food is insufficient, "OK" is blinking.</b></li> </ul>	<ul style="list-style-type: none"> <li>The quantity of food should not exceed 4 cm.</li> <li>Open the grill completely and close it again.</li> <li>Confirm cooking activation by pressing the button .</li> </ul>
The appliance will activate in manual mode +  The indicator light <b>will blink red.</b> + button  temp control and  light fixed	<ul style="list-style-type: none"> <li>Preheating time was cut short.</li> </ul>	<ul style="list-style-type: none"> <li>Monitor the cooking periodically (for use in manual mode). Or</li> <li>Stop the grill, remove food, close the grill, select the new cooking programme you wish to use and wait for the preheating cycle to finish.</li> </ul>

# Cooking Guide (automatic programs)

Dedicated program	Cooking level color indicator		
			
 <b>Red meat</b>	Rare	Medium	Well-done
 <b>Burger</b>	Rare	Medium	Well-done
 <b>Panini / Sandwich</b>	Lightly cooked	Browned	Crispy
 <b>Fish</b>	Lightly cooked	Medium	Well-done
 <b>Poultry</b>			Well cooked
 <b>Pork / Sausages / Lamb</b>			Well cooked

**Tips:** if you want your meat to be very rare (blue), you may use 

# Cooking Guide (including Manual Mode)

Food		Cooking program	Cooking level		
			 rare	 medium	 well-done
<b>Bread</b>	Slices of bread, toasted sandwiches				
	Burger: (after pre-cooking the meat)				
<b>Meat &amp; Poultry</b>	Pork fillet (boneless), pork belly				
	Lamb (boneless)				
	Frozen chicken nuggets 				
	Pork belly				
	Slice of ham to be cooked				
	Marinated chicken breast				
	Duck breast				
<b>Fish</b>	Whole trout				
	Shelled prawns				
	King prawns (with and without shells on)				
	Tuna steak				
<b>Manual mode</b> See the quick start guide for manual mode			4 different temperature settings		

**For frozen food,** press  before selecting your program.

FR	2-19
NL	20-37
DE	38-55
EN	56-73
IT	74-91
ES	92-109
PT	110-127
EL	128-145